

SCHEME FOR THE ESTABLISHMENT

OF

ONE UNIT OF

10,000 Commercial Layer Poultry Farm

Under

U.P. Poultry Development Policy-2022

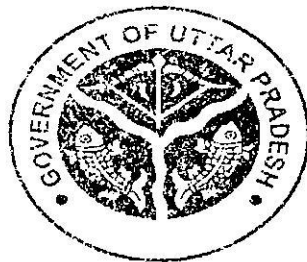

**DEPARTMENT OF ANIMAL HUSBANDRY,
UTTAR PRADESH, LUCKNOW.**

SCHEDULE FOR KEEPING 10000 LAYER

Assumptions:-

The projected rates of various investments are approximate, variation may occur at different places. These are given just for guideline. The entrepreneurs may select his own schedule of placement and system of rearing of birds.

- (i) The project report envisages 10000 commercial layer birds per year.
- (ii) The birds rearing system will have One Brooder cum Grower House for 5000 chicks and Two Layer Houses of 5000 capacity of each. In brooder cum grower house 5000 one day old chick will be reared for first 20 weeks.
- (iii) From grower house these chicks will be transferred in first layer house where these birds will be kept for 52 weeks (one year) i.e. production period. After completing 52 weeks of productions these birds will be sold for table purpose (culled).
- (iv) Two flocks for 5000 DDC chicks will be purchased each year as mentioned in chicks placement schedule (annexure-A)
- (v) Flock will be culled after 72 weeks of age (Annexure-A)
- (vi) Estimated cost of project is Rs. 99.53 lakh.
- (vii) The egg production per female bird per year is assumed 320 (@ 6.15 eggs per week)
- (viii) The average sale price of an egg is estimated Rs. 4.50
- (ix) Sale price of culled bird (72 weeks of age) is assumed Rs. 90/- bird.
- (x) Mortality presumed from 0-20 weeks 5% and from 21-72 weeks 8%
- (xi) Feed consumption during brooding (0-8 week) age will be @ 0.169 kg per chick per week (total 1.352kg/chick) and during growing age (9-18 weeks) @ 0.409 kg/chick/week (Total 4.908 kg/chick). The feed consumption during laying period (52 weeks) will be @ 0.665 kg per bird per week (Total consumption in 52 week will be 34.50 kg per bird)

Prof. P.K. Sunkla
Dean, DUVAS,
Mathura.

12/10/22
DD (P)
ADP

12/10/2022
DD(P-1)
(डा० बृजेश कुमार त्रिपाठी,
उपनिदेशक (कुकुट-1)
निदेशालय, पशुपालन विभाग
लखनऊ (उ० प्र०))

2
द्वितीय निदेशक
पशुपालन विभाग
लखनऊ

निदेशक
शुभ एवं विकास
पशुपालन विभाग
उत्तर प्रदेश, लखनऊ

12-10-2022
(DR. A.K. Tripathi)
Director, CARI
Bareilly

- (ii) The assumed cost of feed during brooding age is Rs. 24/- kg during growing period Rs. 22/- kg. and in laying period Rs. 22.50 per kg
- (iii) Laying period feeding starts from 20 weeks and continue till 72 weeks of age. Total feed consumption during this period will be around 34.50 kg per bird.
- (xiv) The construction cost of brooder cum grower house and adult house is assumed Rs. 495/- per sqft. Other construction costs are mentioned in the scheme.
- (xv) The entrepreneurs share @ 30% will be Rs. 29.85 lac while bank finance @ 70% will be Rs. 69.67 lac
- (xvi) 1st year will be grace period in which only interest will be charged.
- (xvii) Bank loan will be repayed in 5 equal yearly installments starting from 2nd year.
- (xviii) Interest subvention @ 7% as proposed in the scheme will be payed in span on five years from 1st installment released by the bank. It will be maximum Rs 14.61 lac per unit in five years.
- (xiv) All the prices has been kept constant for ease of calculation and on presumption that if the expenditure increases the sale price of egg will also increase accordingly.
- (xx) Land requirement - Maximum One Acre
(100% stamp duty exemption if land is purchased by beneficiaries)
- (xxi) A beneficiary can take max. one unit. Other family member having seperate land ownership are also be eligible to take benefit of the scheme.

(xxii) Total project cost Rs. 99.53 Lac
Margin Money (30%) Rs. 29.85 Lac
Bank Loan (70%) Rs. 69.67 Lac

(xxiii) Subsidy in electricity duty will be given for 10 years @ Rs. 400.00 per months and Rs. 4800.00 per unit per year.

(Prof. P.K. Sunka)
Dean, DUVA
Mathura U.

A
12/10/22
DD(P)
(Signature)
AD-1

(Signature)
DD(P)
12/10/2022
DD(P-1)

वित्त निदेशक
पशुपालन विभाग
उ०प्र०, लखनऊ

निदेशक
प्रशासन एवं विकास
पशुपालन विभाग
उत्तर प्रदेश, लखनऊ

(Dr. A.K. Tiwari)
Director, CARI

(xxiv) This scheme is only for Commercial Layer birds. Producing not less than 300 eggs per annum.

INVESTMENT PER UNIT OF TEN THOUSAND COMMERCIAL LAYER (ESTIMATED)

	Particulars	Rs In lac
1.	LAND (Self/Owned)	1 Acre
2.	BUILDING	
2.a	Land Development & Fencing	2.00
2.b	Water arrangement (deep boring)	0.75
2.c	Brooder cum Grower House for 5000 chicks per lot @ 0.40 sqft per birds. Total area 2000 sqft construction cost @ Rs. 495/- per sqft.	9.90
2.d	Layer House for 10000 adult @ 0.80 sqft /bird total area 10000 sqft construction cost @ Rs. 495/ sqft.	39.60
2.e	Feed Mill & Store 300 Sqft @ 820/ Sqft	2.46
2.f	Office & Store 200 Sqft @ 820/Sqft	1.64
2.g	Supervisor or workers quarter 200 Sqft @820/Sqft	1.64
2.h	Miscellaneous	1.17
	Total (2)	59.53
3.	EQUIPMENTS & MACHINERIES	
3.a	Water arrangement/Drinking System (Over head tanks, Pipeline etc)	0.80
3.b	Grinder, Mixer for Feed mill	2.00
3.c	Generator	1.00
3.d	Brooder cages for 5000 chicks @ Rs. 50/- per chicks	2.50
3.e	Grower cages for 5000 chicks @ Rs. 70/- per chicks	3.50
3.f	Layer cages for 10000 birds @ 100 per bird	10.00
3.g	Miscellaneous Equipments	0.40
3.h	Electrical installation	0.30
	Total (3)	20.50
4.	RECURRING COST	
4.a	Cost of 10000 layer chicks @ Rs. 40/-	4.00
4.b	Feeding cost from 0-20 weeks	12.00
4.c	Medicine & vaccination cost @ 15/chicks	1.50
4.d	Overheads for six months	2.00
	Total	19.50
	Total Cost of the Project	99.53

MEANS OF FINANCE

Total Project Cost Rs. 99.53 Lac
 Loan from Bank (70%) Rs. 69.67 Lac Maximum
 Margin Money (30%) Rs. 29.85 Lac Minimum

12/10/22
 DD (CD)
 AD-1

12/10/2022
 DD (P-1)

3000

4
 वित्त नियंत्रक
 पशुपालन विभाग
 लखनऊ

निदेशक
 पशुपालन एवं विकास
 पशुपालन विभाग
 उत्तर प्रदेश, लखनऊ

Handwritten signature

INCOME & EXPENDITURE

(A) INCOME

From Sale of eggs and culls

Year	Batch size	Total layer weeks (no)	Prod./bird /week nos	Total egg prod (no lac)	Egg Sale price Rs/egg	Total sale value (A) Rs (Lac)	Total culled birds no	Culls price Rs/bird	Cull income Rs Lac (B)	Total (A+B) Income in Lac
I	5000	47	5.76/ week	13.53	4.50	60.885	-	-	-	60.885
II	5000	104	5.76/ week	29.95	4.50	134.775	9200	90.00	8.28	143.055
III	5000	104	5.76/ week	29.95	4.50	134.775	9200	90.00	8.28	143.055
IV	5000	104	5.76/ week	29.95	4.50	134.775	9200	90.00	8.28	143.055
V	5000	104	5.76/ week	29.95	4.50	134.775	9200	90.00	8.28	143.055
VI	5000	104	5.76/ week	29.95	4.50	134.775	9200	90.00	8.28	143.055

B- EXPENDITURE

B- (i) Brooding Phase

Year	Batch size	Brooding weeks	Feed consumption per bird/week (kg)	Total feed consumption (kg)	Cost of the feed Rs/kg	Total cost of feed (Rs. Lac)	Medicine+ Vaccine expenditure @ Rs/bird/ year	Cost of Medi+ vacc. Rs. Lac/year	Total Expenditure (7+9)
1	2	3	4	5	6	7	8	9	10
I	5000	16	0.169	13520	24/kg	3.24480	14.00	1.40	4.64480
II	5000	16	0.169	13520	24/kg	3.24480	14.00	1.40	4.64480
III	5000	16	0.169	13520	24/kg	3.24480	14.00	1.40	4.64480
IV	5000	16	0.169	13520	24/kg	3.24480	14.00	1.40	4.64480
V	5000	16	0.169	13520	24/kg	3.24480	14.00	1.40	4.64480
VI	5000	16	0.169	13520	24/kg	3.24480	14.00	1.40	4.64480

B- (ii) Growing Phase

Year	Batch size	Brooding weeks	Feed consumption per bird/week (kg)	Total feed consumption (kg)	Price of the feed Rs/kg	Total cost of feed (Rs. Lac)	Medicine+ Vaccine expenditure @ Rs. lac/year	Cost of Medi- vacc. Rs in Lac/year	Total Expenditure (7+9) (Rs. In lac)
1	2	3	4	5	6	7	8	9	10
I	5000	24	0.409	49080	22 /kg	10.79	4.00	0.40	11.19
II	5000	24	0.409	49080	22 /kg	10.79	4.00	0.40	11.19
III	5000	24	0.409	49080	22 /kg	10.79	4.00	0.40	11.19
IV	5000	24	0.409	49080	22 /kg	10.79	4.00	0.40	11.19
V	5000	24	0.409	49080	22 /kg	10.79	4.00	0.40	11.19
VI	5000	24	0.409	49080	22 /kg	10.79	4.00	0.40	11.19

12/10/22
DD (P)
AD-1

12/10/22

5

वित्त नियंत्रक
पशुपालन विभाग
लखनऊ

निदेशक
प्रशासन एवं विकास
पशुपालन विभाग
उत्तर प्रदेश

B- (iii) Laying Phase

Year	Batch size	Laying weeks (No)	Feed consumption per bird/week (kg)	Total feed consumption (kg)	Cost of the feed Rs/kg	Total cost of feed (Rs. Lac)	Medicine+ Vaccine expenditure @ Rs. per birds	Cost of Medi+ vaccine cost Rs. in Lac	Total Expenditure Rs. in Lac (7+9)
1	2	3	4	5	6	7	8	9	10
I	5000	47	0.750	156040	22.50	35.11	15.00	1.50	36.60
II	5000	104	0.750	345280	22.50	77.68	15.00	1.50	79.18
III	5000	104	0.750	345280	22.50	77.68	15.00	1.50	79.18
IV	5000	104	0.750	345280	22.50	77.68	15.00	1.50	79.18
V	5000	104	0.750	345280	22.50	77.68	15.00	1.50	79.18
VI	5000	104	0.750	345280	22.50	77.68	15.00	1.50	79.18

B- (iv) Chick Purchase Cost

Year	Batch Size	Total batches	Total Chicks	Total cost @ Rs 40/chick
I	5000	2	10000	400000
II	5000	2	10000	400000
III	5000	2	10000	400000
IV	5000	2	10000	400000
V	5000	2	10000	400000
VI	5000	2	10000	400000

B- (v) Salaries Wages and Other

SNo.	Description	No	Salary Per Month (in Rs.)	Yearly (in Rs.)	1 st Year (6 Month) In Rs.
1.	Supervisor	1	7000	84000	42000
2.	Skilled Worker	1	6000	72000	36000
3.	Unskilled	3	4000	144000	72000
4.	Misc Exp.	-	2000	24000	12000
	Total			324000	162000

12/10/22
DDCP)

12/10/2022
AD-1

Pr JDP

द्वितीय नियंत्रक
पशुपालन विभाग
ब० प्र०, लखनऊ

निदेशक
प्रशासन एवं विकास
पशुपालन विभाग
उत्तर प्रदेश, लखनऊ

[Handwritten Signature]

(B. vi). Bank Repayment (Rs. in Lac)

Year	Loan Amount	Repayment Principal Amount	Repayment Interest @ 9%	Interest subvention by Govt. @ 7% Maximum	Total to Bank (3+4)	Total Net paid by Investor (3+4)-5
1	2	3	4	5	6	7
I	69.67	Grace period	-	-	-	-
II	69.67	13.93	6.17	4.87	20.10	15.23
III	55.74	13.93	4.94	3.90	18.87	14.97
IV	41.81	13.93	3.70	2.92	17.63	14.71
V	27.88	13.93	2.47	1.95	16.40	14.45
VI	13.95	13.93	1.23	0.97	15.16	14.19
	Total	69.67	18.51	14.61	88.16	73.55

B. vii Annual Profit and Loss (In Lac)

Description	Year-I	Year-II	Year-III	Year-IV	Year-V	Year-VI
INCOME (A)						
Sale of Eggs	60.885	134.775	134.775	134.775	134.775	134.775
Sale of Culls	-	8.280	8.280	8.280	8.280	8.280
Sale of Mannure	-	-	-	-	-	-
Total	60.885	143.055	143.055	143.055	143.055	143.055
EXPENDITURE (B)						
Cost of Chicks	4.00	4.00	4.00	4.00	4.00	4.00
Brooding Phase	4.64	4.64	4.64	4.64	4.64	4.64
Growing Phase	11.19	11.19	11.19	11.19	11.19	11.19
Laying Phase	36.61	79.18	79.18	79.18	79.18	79.18
Overheads	2.00	2.00	2.00	2.00	2.00	2.00
Total (B)	58.44	101.76	101.76	101.76	101.76	101.76
(C) Gross Income (A-B) Less (-)	2.44	41.295	41.295	41.295	41.295	41.295
Bank Principal (D)	-	13.93	13.93	13.93	13.93	13.93
Net Bank Interest Paid (E)	-	1.37	1.10	0.82	0.55	0.27
(F) Net Income after interest subvention @ 7% (C-D-E)	2.44	25.99	26.265	26.535	26.815	27.095

12/10/22
100 (D)

(डा० बृजेश कुमार त्रिपाठी)
उपनिदेशक (कुक्कुट-1)
निदेशालय, पशुपालन विभाग
लखनऊ (उ० प्र०)

विकास निदेशक
पशुपालन विभाग
उ० प्र०, लखनऊ

निदेशक
प्रशासन एवं विकास
पशुपालन विभाग
उत्तर प्रदेश, लखनऊ

(DR. A.K. Tiwari)
Director (ARI)

(Prof. P.K. Suck)

PROPOSED POULTRY FARM UNDER
UTTAR PRADESH KUKKUT VIKAS NITI 2022

NOTES:

1. ALL DIMENSIONS ARE GIVEN IN MM
2. ALL WRITTEN DIMENSIONS SHOULD BE FOLLOWED.
3. DRAWINGS SHOULD BE CHECKED AND VERIFIED AS PER SAFE CONSTRUCTION BEFORE EXECUTION OF THE WORK BY THE EXECUTIVE ENGINEER CONCERNED.
4. ANY DISCREPANCY FOUND IN THE DRAWINGS SHOULD BE BROUGHT TO THE NOTICE OF THE ARCHITECT CONCERNED.
5. BEFORE EXECUTION OF WORK THE EXECUTIVE ENGINEER SHOULD OBTAIN THE APPROVAL OF COMPETENT AUTHORITY ON THE SPACES PROVIDED.
6. SIX INCHES SPACING OF COLUMNS SHALL BE AS PER THE STRUCTURAL DESIGN DETAIL OF TRUSS BEAMS S.A.B.2 FOUNDATION SHALL BE AS PER THE STRUCTURAL DETAIL.
7. The drawings are prepared in the letter from Pk444, written by Rajni, Rajni Rajni, street 4421, Gurgaon, Haryana in 19/10/2022 which have deviations from standards of CARI, CENTRAL AVIATION RESEARCH INSTITUTE (center provided vide letter from Rajni, Rajni Rajni, street 4421, Gurgaon, Haryana in 19/10/2022 - 23 No. 16/9/2022). Hence PWD shall not be liable for any discrepancies and problems arising due to deviation w.r.t standards.
8. DIMENSIONS AND AREA SHOWN IN P.F.F. AND IN BETWEEN [] ARE ONLY FOR REFERENCE PURPOSE.

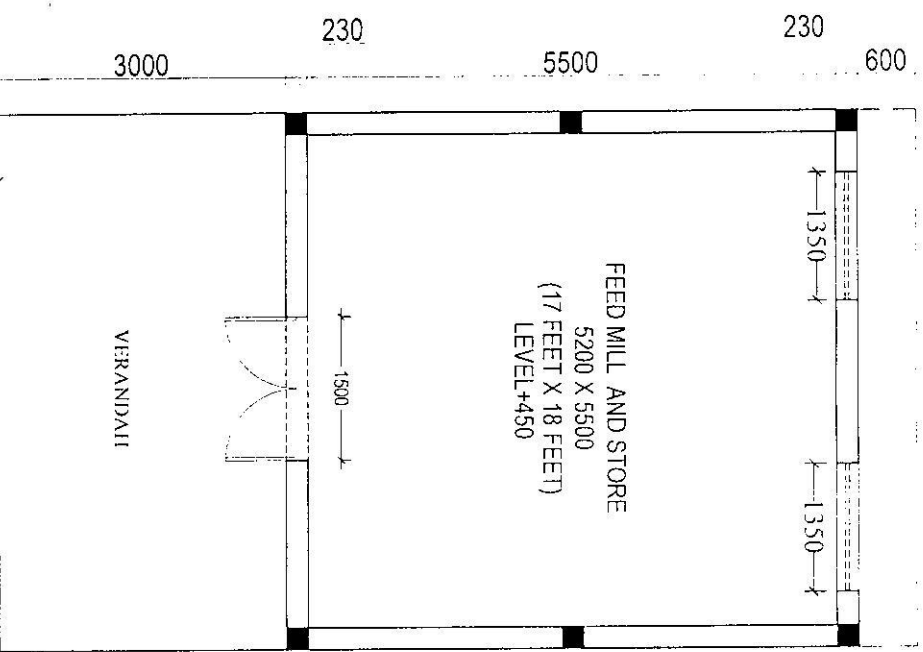

GROUND FLOOR PLAN

FOR APPROVAL ONLY

AREA STATEMENT:
PLINTH AREA ON GROUND FLOOR = 59.86 SQ. MT.

DRG. No. PROPOSED 10,000
DATE 8-11-2022 BIRD CAPACITY LAYING UNIT

DRAWN BY PUSHPAM
VASTUVID VARG
& STORE BUILDING

SABERNA SINGH
CHIEF ARCHITECT
KARYALAYA PRAMUKH ABHIVYAKTA
LOK NIRMAN VIBHAG, U.P. LOCKNOWN

HIRANSHU YADAV
ASST. ARCHITECT
BRUSH KUMAR
SR. ARCHITECT
SABERNA SINGH
SR. ARCHITECT

10.11.21

